



COLLINSVILLE PLANNING COMMISSION

AGENDA

Thursday, May 20th, 2021 @ 6:30 PM
Commission Meeting Room | City Hall
106 North 12th Street
Collinsville, Oklahoma

1. **Call to order**
2. **Roll Call**
3. **Approval of Minutes from the April 15th, 2021 Planning Commission Meeting.**
4. **PUBLIC HEARING: Regarding Annexation 2021-01.1 and CZ-218**

Annexation and Rezoning Applications from Mr. Kyle Smalygo of Collinsville, OK requesting a review of the annexation and rezoning proposal for parcel # 92430-24-30-50490 near Stonegate Estates.

Legal Description:

BEGINNING at North west corner of Lot 4 Block 7 of the N/2 Section of Stonegate Estates; THENCE West 457.54 feet; THENCE South 570.26 feet; THENCE West 72.30 feet; THENCE North 1,030 feet; THENCE East 527.54 feet; THENCE South 459.74 feet to the POINT OF BEGINNING on the South West corner of Lot 10 Block 4 of Stonegate Estates.

- a. Discussion and possible action.

5. **PUBLIC HEARING: Regarding Annexation 2021-03**

Annexation Application 2021-03 from Mr. Mark G. Allen requesting a review of the annexation proposal for the parcel owned by TUL 2 Partners LLC. that is a part of the Southeast Quarter of the Northeast Quarter (SE/4 NE/4) and that part of the North Half of the Southwest Quarter of the Northeast Quarter (N/2 SW /4 NE/4) lying East of the proposed Mingo Valley Expressway in Section Twenty-one (21), Township Twenty-two (22) North, Range Fourteen (14) East of the Indian Base and Meridian, Tulsa County, State of Oklahoma.

Legal Description:

BEGINNING at the South east corner of said SE/4 of the NE/4; THENCE South 88°25'51" West along the South line of said SE/4 of the NE/4 a distance of 1322.76 feet to the South west corner of said SE/4 of the NE/4; THENCE North 01° 15'17" West along the West line of said SE/4 of the NE/4 a distance of 662.12 feet to the South east corner of said N/2 of the SW/4 of the NE/4; THENCE South 88°24'17" West along the South line of said N/2 of the SW/4 of the NE/4 a distance of 227.26 feet to a point on the East Right-of-Way line of the proposed Mingo Valley Expressway; THENCE Northeasterly along said Right-of-Way line along a curve to the right having a radius of 21,345.92 feet a distance of 720.21 feet; THENCE North 28°40'42" West a distance of 58.89 feet to a point on the North line of said SE/4 of the NE/4; THENCE North 88°22'43" East along the North line of said SE/4 of the NE/4 a distance of 1122.15 feet to the Northeast corner of said SE/4 of the NE/4; THENCE South 1°14'24" West along the East line of said SE/4 of the NE/4 a distance of 1326.50 feet to the POINT OF BEGINNING.

- a. Discussion and possible action.

6. PUBLIC HEARING: Regarding Final Plat Review of Cherry Creek Phase II

- a. Discussion and possible action.

7. Other Business

8. Adjournment

See Maps Below for Reference:

City of Collinsville

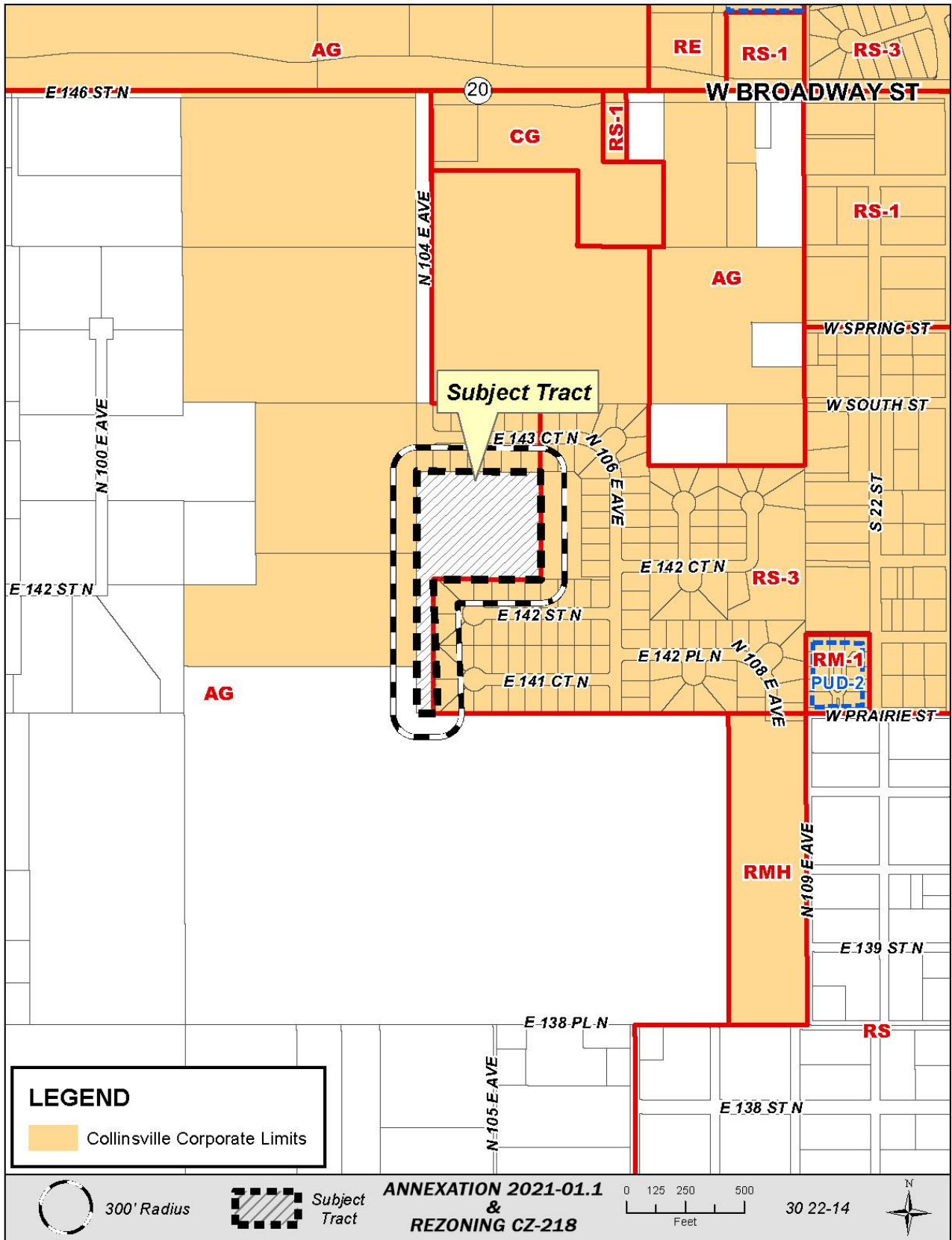

City of Collinsville

